

# GAU-80mm-ATI

General Aviation Artificial Horizon



## Main Features

- True to original appearance
- full aluminium housing / carbon tube
- max bank 60° / max pitch 40°
- CAN Master Controller needed

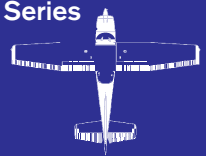

# GAU-80mm-ATI

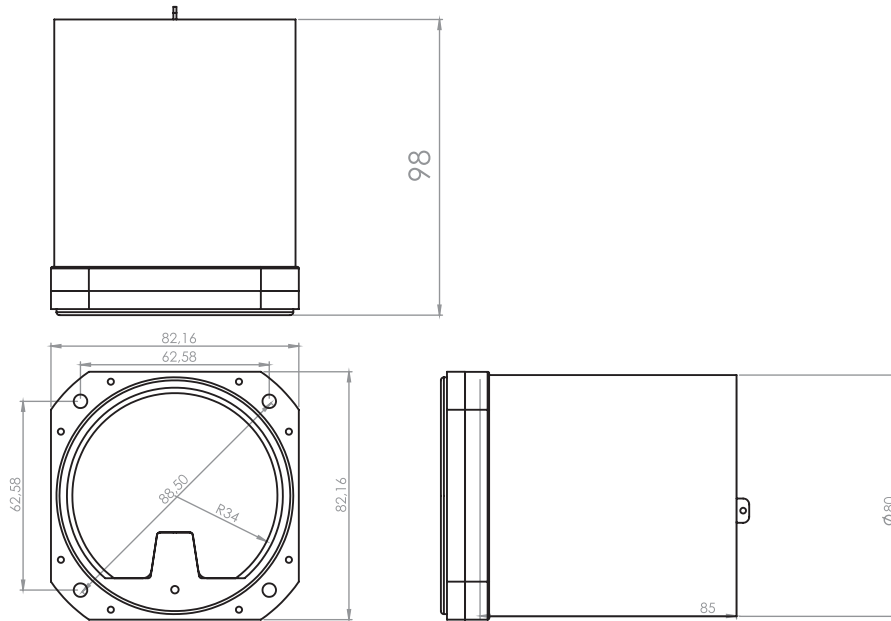

## GENERAL SPECIFICATIONS

### Characteristics

Size:	82,16 x 82,16 x 98 mm (Tube diameter 79,5mm)
Weight:	200 g
Colour:	housing black anodized
Temperature range:	5° - 65°

### Power

Connector:	open 30° switch (integrated)
Backlighting Power:	-
Cooling:	passive

### Interface

Data I/O:	CAN-bus interface available
Connector:	CANbus - Sub-D 9
Max. speed:	1 Mbit

### Mode of operation

Backlighting:	na
Software:	DCS / FSX / P3D /
Functions:	full moving artificial Horizon (60°/40°)